

The Company Director and/or Secretary
Seales Road Haulage Limited
14 Broadway
Rainham
Essex
RM13 9YW

Our ref: **EPR/AB3408HK/A001**

Date: **1 November 2013**

Dear Sir or Madam

Your new environmental permit

Permit reference: EPR/AB3408HK/A001

Waste returns reference: EAWML 400635

Operator: Seales Road Haulage Limited

Facility: Seales Road Haulage Limited, 20 Juliette Way, Purfleet Industrial Estate, South Ockendon, Essex, RM15 4YD

Our determination of your application for a permit is complete. We're satisfied that you can carry out your activities in accordance with the enclosed permit, without harm to the environment or human health. I enclose your new permit. Please keep it in a safe place.

This letter contains web links to other documents. If you aren't able to access these phone our Customer Contact Centre for help.

You need to read our document 'How to comply with your environmental permit'. This will help you understand what you need to do to meet the conditions of your permit. You can find this on our guidance web page at

<http://www.environment-agency.gov.uk/business/topics/permitting/32320.aspx>

Please look at the table below and note any of the things that apply to your permit.

If...	then..
you plan to keep your records at a site other than where the activity takes place	you need to let us know within 20 working days of receiving this letter.
your permit includes pre-operational or improvement conditions	check the deadlines for completing measures and make sure you carry them out by the times stated
you are carrying out a waste operation or activity and need to submit quarterly waste returns on waste movements	you can get the forms you need from our website http://www.environment-agency.gov.uk/business/topics/waste/32176.aspx
Note: This does not apply to permits that only have stand alone water discharge or groundwater activities.	When you complete your return use the waste returns reference above.
your permit includes an installation	we enclose a legal notice and information about reporting to the Pollution Inventory.
you need to submit other returns	send these to your area office. Speak to your area officer to check local arrangements.



Schedule 1 - Operations

Table S1.1 activities

Description of activities for waste operations	Limits of activities
R13: Storage of waste pending any of the operations numbered R1 to R12 (excluding temporary storage, pending collection, on the site where it is produced)	Treatment of wastes listed in table S2.1 consisting only of sorting, separation, screening, crushing, and blending of waste for recovery as a soil, soil substitute or aggregate.
R3: Recycling/reclamation of organic substances which are not used as solvents	Secure storage of wastes listed in table S2.1 pending treatment
R5: Recycling/reclamation of other inorganic compounds	<p>Storage of wastes shall not exceed 40,000 tonnes in total at any one time.</p> <p>All permitted wastes shall be stored and treated on hard-standing or on an impermeable surface with sealed drainage system.</p> <p>No more than 250,000 tonnes of waste shall be treated per year</p>

Table S1.2 Operating techniques

Description	Parts	Date Received
-	-	-

Schedule 2 - Waste types, raw materials and fuels

Table S2.1 permitted waste types and quantities	
Maximum quantity 250,000 tonnes per annum	
Exclusions Wastes having any of the following characteristics shall not be accepted: <ul style="list-style-type: none"> • Consisting solely or mainly of dusts, powders or loose fibres • Hazardous wastes • Wastes in liquid form 	
Waste Code	Description
01	WASTES RESULTING FROM EXPLORATION, MINING, QUARRYING, AND PHYSICAL AND CHEMICAL TREATMENT OF MINERALS
01 04	wastes from physical and chemical processing of non-metalliferous minerals
01 04 08	waste gravel and crushed rocks other than those mentioned in 01 04 07
01 04 09	waste sand and clays
02	WASTES FROM AGRICULTURE, HORTICULTURE, AQUACULTURE, FORESTRY, HUNTING AND FISHING, FOOD PREPARATION AND PROCESSING
02 02	wastes from the preparation and processing of meat, fish and other foods of animal origin
02 02 02	animal-tissue waste
03	WASTES FROM WOOD PROCESSING AND THE PRODUCTION OF PANELS AND FURNITURE, PULP, PAPER AND CARDBOARD
03 01	wastes from wood processing and the production of panels and furniture
03 01 01	waste bark and cork
03 03	wastes from pulp, paper and cardboard production and processing
03 03 01	waste bark and wood
10	WASTES FROM THERMAL PROCESSES
10 01	wastes from power stations and other combustion plants (except 19)
10 01 01	bottom ash, slag and boiler dust (excluding boiler dust mentioned in 10 01 04)
10 01 02	coal fly ash
10 01 05	calcium-based reaction wastes from flue-gas desulphurisation in solid form
10 01 07	calcium-based reaction wastes from flue-gas desulphurisation in sludge form
10 01 15	bottom ash, slag and boiler dust from co-incineration other than those mentioned in 10 01 14
10 11	wastes from manufacture of glass and glass products
10 11 12	waste glass other than those mentioned in 10 11 11
10 12	wastes from manufacture of ceramic goods, bricks, tiles and construction products



This form will report compliance with your permit as determined by an Environment Agency officer

Site	Seales Road Haulage Ltd	Permit Ref	400635		
Operator/ Permit holder	Seales Road Haulage Limited				
Date	08/04/2014	Time in	11:50	Out	13:00
What parts of the permit were assessed	A, B, C, D, F, G				
Assessment	Site Inspection	EPR Activity:	Installation	Waste Op	X Water Discharge
Recipient's name/position	Peter Seales, TCM & Director				
Officer's name	Ross Bigley	Date issued	10/04/2014		

Section 1 - Compliance Assessment Summary

This is based on the requirements of the permit under the Environmental Permitting Regulations. A detailed explanation and any action you may need to take are given in the "Detailed Assessment of Compliance" (section 3). This summary details where we believe any non-compliance with the permit has occurred, the relevant condition and how the non-compliance has been categorised using our [Compliance Classification Scheme \(CCS\)](#). CCS scores can be consolidated or suspended, where appropriate, to reflect the impact of some non-compliances more accurately. For more details of our CCS scheme, contact your [local office](#).

Permit Conditions and Compliance Summary			Condition(s) breached
a) Permitted activities	1. Specified by permit	C3	2.1.1;
b) Infrastructure	1. Engineering for prevention & control of pollution	A	
	2. Closure & decommissioning	NA	
	3. Site drainage engineering (clean & foul)	N	
	4. Containment of stored materials	A	
	5. Plant and equipment	A	
c) General management	1. Staff competency/ training	A	
	2. Management system & operating procedures	C4	1.1.1(a);
	3. Materials acceptance	A	
	4. Storage handling, labelling, segregation	A	
d) Incident management	1. Site security	A	
	2. Accident, emergency & incident planning	N	
e) Emissions	1. Air	N	
	2. Land & Groundwater	N	
	3. Surface water	N	
	4. Sewer	N	
	5. Waste	N	
f) Amenity	1. Odour	A	
	2. Noise	A	
	3. Dust/fibres/particulates	A	
	4. Pests, birds & scavengers	A	
	5. Deposits on road	C3	3.1.1;
g) Monitoring and records, maintenance and reporting	1. Monitoring of emissions & environment	N	
	2. Records of activity, site diary, journal & events	A	
	3. Maintenance records	N	
	4. Reporting & notification	N	
h) Resource efficiency	1. Efficient use of raw materials	N	
	2. Energy	N	

KEY: C1, C2, C3, C4 = CCS breach category (* suspended scores are marked with an asterisk),
A = Assessed (no evidence of non-compliance), N = Not assessed, NA = Not Applicable, O = Ongoing non-compliance – not scored

Number of breaches recorded	3	Total compliance score (see section 5 for scoring scheme)	8.1
------------------------------------	---	---	-----

If the Total No Breaches is greater than zero, then please see Section 3 for details of our proposed enforcement response

Section 2 – Compliance Assessment Report Detail

This section contains a report of our findings and will usually include information on:

- the part(s) of the permit that were assessed (e.g. maintenance, training, combustion plant, etc)
- where the type of assessment was 'Data Review' details of the report/results triggering the assessment
- any non-compliances identified
- any non-compliances with directly applicable legislation
- details of any multiple non-compliances
- information on the compliance score accrued inc. details of suspended or consolidated scores.
- details of advice given
- any other areas of concern
- all actions requested
- any examples of good practice.
- a reference to photos taken

This report should be clear, comprehensive, unambiguous and normally completed within 14 days of an assessment.

Site inspection carried out on 8 April between 1150 and 1300 as a response to NIRS report 1224894. Weather was clear and dry, light breeze.

The site itself continues to be in good order throughout. The dust suppression system is in place (though was not needed during the time of the inspection). The surface of the site is in good condition and the re-arranging of operations within the permitted area appears to have given more working space. The site security is sound. Plans to increase the size of the permitted area were mentioned. Please consult with me if this goes ahead so appropriate variations to the permit can be put in place.

F5 Amenity - Deposits on road: Permit Condition 3.1.1 CCS score C3

Observation: There was a quantity of mud which had been tracked onto the road from the site entrance. This needs to be cleared as soon as possible. Thought should be given to mitigating measures such as installing wheel-washing equipment for vehicles leaving site or more regular use of the road sweeping equipment.

A1 Specified Activities: Permit Condition 2.1.1 CCS score C3

Observation: The fire reported in NIRS 1224894 was confirmed in conversation with Peter Seales. This is an unpermitted disposal of waste and should not be repeated.

C2 Management - Management systems and operating procedures: Permit Condition 1.1.1 CCS score C4

Observation: The site's Environmental Management System needs to be compiled. Please contact me for advice if required.



This form will report compliance with your permit as determined by an Environment Agency officer

Site	Seales Road Haulage Ltd	Permit	400635
Operator/ Permit	Seales Road Haulage Limited	Date	08/04/2014

Section 3- Enforcement Response **Only one of the boxes below should be ticked**

<p>You must take immediate action to rectify any non-compliance and prevent repetition. Non-compliance with your permit conditions constitutes an offence and can result in criminal prosecutions and/or suspension or revocation of a permit. Please read the detailed assessment in Section 2 and the steps you need to take in Section 4 below.</p>	
<p>Other than the provision of advice and guidance, at present we do not intend to take further enforcement action in respect of the non-compliance identified above. This does not preclude us from taking enforcement action if further relevant information comes to light or advice isn't followed.</p>	X
<p>In respect of the above non-compliance you have been issued with a warning. At present we do not intend to take further enforcement action. This does not preclude us from taking additional enforcement action if further relevant information comes to light or offences continue.</p>	
<p>We will now consider what enforcement action is appropriate and notify you, referencing this form.</p>	

Section 4- Action(s)

Where non-compliance has been detected and an enforcement response has been selected above, this section summarises the steps you need to take to return to compliance and also provides timescales for this to be done.

Criteria Ref.	CCS Category	Action Required/Advised	Due Date
See Section 1 above			
A1	C3	No more burning waste on site.	N/A
C2	C4	Complete Environmental Management System	N/A
F5	C3	Keep road free from deposits of mud from site.	N/A

Section 5 - Compliance notes for the Operator

To ensure you correct actual or potential non-compliance we may

- advise on corrective actions verbally or in writing
- require you to take specific actions in writing
- issue a notice
- require you to review your procedures or management system
- change some of the conditions of your permit
- decide to undertake a full review of your permit

Any breach of a permit condition is an offence and we may take legal action against you.

● We will normally provide advice and guidance to assist you to come back into compliance either after an offence is committed or where we consider that an offence is likely to be committed. This is without prejudice to any other enforcement response that we consider may be required.

● Enforcement action can include the issue of a formal caution, prosecution, the service of a notice and or suspension or revocation of the permit.

See our Enforcement and Civil Sanctions guidance for further information

This report does not relieve the site operator of the responsibility to

- ensure you comply with the conditions of the permit at all times and prevent pollution of the environment
- ensure you comply with other legislative provisions which may apply.

Non-compliance scores and categories

CCS category	Description	Score
C1	A non-compliance which could have a major environmental effect	60
C2	A non-compliance which could have a significant environmental effect	31
C3	A non-compliance which could have a minor environmental effect	4
C4	A non-compliance which has no potential environmental effect	0.1

Operational Risk Appraisal (Opra) - Compliance assessment findings may affect your Opra score and/or your charges. This score influences the resource we use to assess permit compliance.

Section 6 – General Information

Data protection notice

The information on this form will be processed by the Environment Agency to fulfill its regulatory and monitoring functions and to maintain the relevant public register(s). The Environment Agency may also use and/or disclose it in connection with:

- offering/providing you with its literature/services relating to environmental matters
- consulting with the public, public bodies and other organisations (e.g. Health and Safety Executive, local authorities) on environmental issues
- carrying out statistical analysis, research and development on environmental issues
- providing public register information to enquirers
- investigating possible breaches of environmental law and taking any resulting action
- preventing breaches of environmental law
- assessing customer service satisfaction and improving its service
- Freedom of Information Act/Environmental Information Regulations request.

The Environment Agency may pass it on to its agents/representatives to do these things on its behalf. You should ensure that any persons named on this form are informed of the contents of this data protection notice.

Disclosure of information

The Environment Agency will provide a copy of this report to the public register(s). However, if you consider that any information contained in this report should not be released to the public register(s) on the grounds of commercial confidentiality, you must write to your local area office within 28 days of receipt of this form indicating which information it concerns and why it should not be released, giving your reasons in full.

Customer charter

What can I do if I disagree with this compliance assessment report?

If you are unable to resolve the issue with your site officer, you should firstly discuss the matter with the officer's line managers. If you wish to raise your dispute further through our official Complaints and Commendations procedure, phone our general enquiry number 03708 506 506 (Mon to Fri 08.00–18.00) and ask for the Customer Contact team or send an email to enquiries@environment-agency.gov.uk. If you are still dissatisfied, you can make a complaint to the Ombudsman. For advice on how to complain to the [Parliamentary and Health Service Ombudsman](#) phone their helpline on 0345 015 4033.



This form will report compliance with your permit as determined by an Environment Agency officer

Site	Seales Road Haulage Ltd	Permit	400635
Operator/ Permit	Seales Road Haulage Limited	Date	01/02/2014

Section 3- Enforcement Response

Only one of the boxes below should be ticked:

<p>You must take immediate action to rectify any non-compliance and prevent repetition. Non-compliance with your permit conditions constitutes an offence and can result in criminal prosecutions and/or suspension or revocation of a permit. Please read the detailed assessment in Section 2 and the steps you need to take in Section 4 below.</p>	
<p>Other than the provision of advice and guidance, at present we do not intend to take further enforcement action in respect of the non-compliance identified above. This does not preclude us from taking enforcement action if further relevant information comes to light or advice isn't followed.</p>	X
<p>In respect of the above non-compliance you have been issued with a warning. At present we do not intend to take further enforcement action. This does not preclude us from taking additional enforcement action if further relevant information comes to light or offences continue.</p>	
<p>We will now consider what enforcement action is appropriate and notify you, referencing this form.</p>	

Section 4- Action(s)

Where non-compliance has been detected and an enforcement response has been selected above, this section summarises the steps you need to take to return to compliance and also provides timescales for this to be done.

Criteria Ref.	CCS Category	Action Required/Advised	Due Date
See Section 1 above			
G4	C4	If you have not already sent in your waste return for period Oct-Dec 13 please send it within 4 weeks of the date of this CAR form. Returns were due by 31st Jan 14. In future please make sure your returns are submitted on time as per your permit conditions.	N/A

10 12 08	waste ceramics, bricks, tiles and construction products (after thermal processing)
10 13	wastes from manufacture of cement, lime and plaster and articles and products made from them
10 13 14	waste concrete and concrete sludge
15	WASTE PACKAGING; ABSORBENTS, WIPING CLOTHS, FILTER MATERIALS AND PROTECTIVE CLOTHING NOT OTHERWISE SPECIFIED
15 01	packaging (including separately collected municipal packaging waste)
15 01 07	glass packaging
17	CONSTRUCTION AND DEMOLITION WASTES (INCLUDING EXCAVATED SOIL FROM CONTAMINATED SITES)
17 01	concrete, bricks, tiles and ceramics
17 01 01	concrete
17 01 02	bricks
17 01 03	tiles and ceramics
17 01 07	mixtures of concrete, bricks, tiles and ceramics other than those mentioned in 17 01 06
17 02	wood, glass and plastic
17 02 02	glass
17 03	bituminous mixtures, coal tar and tarred products
17 03 02	bituminous mixtures other than those mentioned in 17 03 01
17 05	soil (including excavated soil from contaminated sites), stones and dredging spoil
17 05 04	soil and stones other than those mentioned in 17 05 03
17 05 06	dredging spoil other than those mentioned in 17 05 05
17 05 08	track ballast other than those mentioned in 17 05 07
17 08	gypsum-based construction material
17 08 02	gypsum-based construction materials other than those mentioned in 17 08 01
19	WASTES FROM WASTE MANAGEMENT FACILITIES, OFF-SITE WASTE WATER TREATMENT PLANTS AND THE PREPARATION OF WATER INTENDED FOR HUMAN CONSUMPTION AND WATER FOR INDUSTRIAL USE
19 05	wastes from aerobic treatment of solid wastes
19 05 03	off-specification compost
19 08	wastes from waste water treatment plants not otherwise specified
19 08 02	waste from desanding
19 08 99	wastes not otherwise specified
19 09	wastes from the preparation of water intended for human consumption or water for industrial use
19 09 02	sludges from water clarification
19 12	wastes from the mechanical treatment of waste (for example sorting, crushing, compacting, pelletising) not otherwise specified
19 12 05	glass
19 12 09	minerals (for example sand, stones)
19 12 12	other wastes (including mixtures of materials) from mechanical treatment of wastes other than those mentioned in 19 12 11
19 13	wastes from soil and groundwater remediation

19 13 02	solid wastes from soil remediation other than those mentioned in 19 13 01
19 13 04	sludges from soil remediation other than those mentioned in 19 13 03
20	MUNICIPAL WASTES (HOUSEHOLD WASTE AND SIMILAR COMMERCIAL, INDUSTRIAL AND INSTITUTIONAL WASTES) INCLUDING SEPARATELY COLLECTED FRACTIONS
20 01	separately collected fractions (except 15 01)
20 01 02	glass
20 02	garden and park wastes (including cemetery waste)
20 02 02	soil and stones

Schedule 4 - Reporting

There is no reporting under this schedule.

Schedule 6 - Interpretation

"accident" means an accident that may result in pollution.

"application" means the application for this permit, together with any additional information supplied by the operator as part of the application and any response to a notice served under Schedule 5 to the EP Regulations.

"authorised officer" means any person authorised by the Environment Agency under section 108(1) of The Environment Act 1995 to exercise, in accordance with the terms of any such authorisation, any power specified in section 108(4) of that Act.

"EP Regulations" means The Environmental Permitting (England and Wales) Regulations SI 2010 No.675 and words and expressions used in this permit which are also used in the Regulations have the same meanings as in those Regulations.

"emissions of substances not controlled by emission limits" means emissions of substances to air, water or land from the activities, either from the emission points specified in schedule 3 or from other localised or diffuse sources, which are not controlled by an emission or background concentration limit.

"groundwater" means all water, which is below the surface of the ground in the saturation zone and in direct contact with the ground or subsoil.

"hazardous waste" has the meaning given in the Hazardous Waste (England and Wales) Regulations 2005 No.894, the Hazardous Waste (Wales) Regulations 2005 No. 1806 (W.138), the List of Wastes (England) Regulations 2005 No.895 and the List of Wastes (Wales) Regulations 2005 No. 1820 (W.148).

"quarter" means a calendar year quarter commencing on 1 January, 1 April, 1 July or 1 October.

"R" means a recovery operation provided for in Annex II to Directive 2008/98/EC of the European Parliament and of the Council on waste.

"Waste code" means the six digit code referable to a type of waste in accordance with the List of Wastes (England) Regulations 2005, or List of Wastes (Wales) Regulations 2005, as appropriate, and in relation to hazardous waste, includes the asterisk.

"year" means calendar year ending 31 December.

Schedule 7 - Site plan

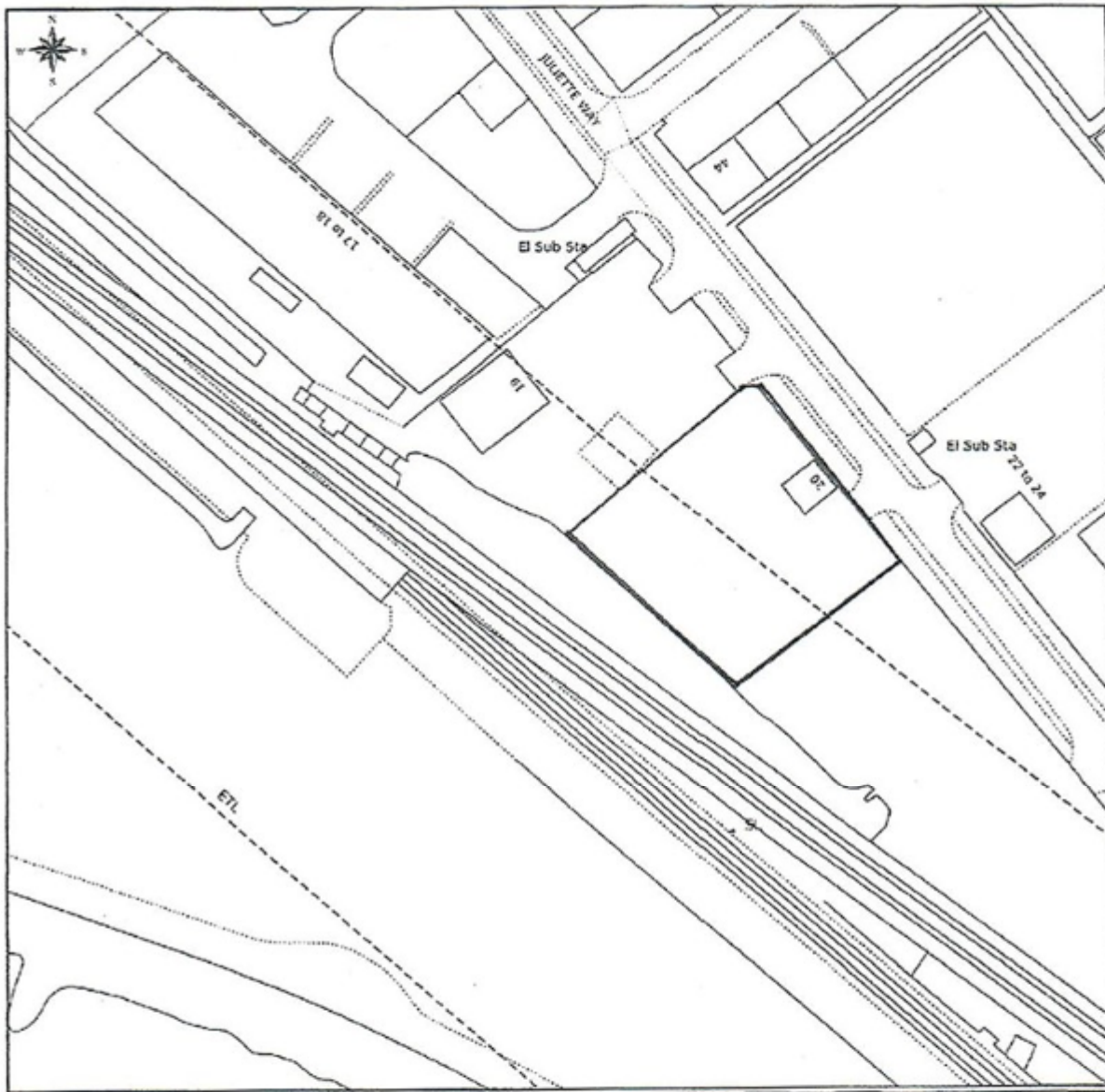

This Plan includes the following Licensed Data: OS MasterMap Black and White PDF Site Data by the Ordnance Survey National Geographical Database and incorporating surveyed revision available at the date of production. Reproduction in whole or in part is prohibited without the prior permission of Ordnance Survey. The representation of a road, track or path is no evidence of a right of way. The representation of features as lines is no evidence of a property boundary. © Crown copyright. All rights reserved 2013. Licence number 0100021673

Scale: 1:1500, paper size: A4

END OF PERMIT



This form will report compliance with your permit as determined by an Environment Agency officer.

Site	Seales Road Haulage Ltd	Permit Ref	400635
Operator/ Permit holder	Seales Road Haulage Limited		
Date	01/02/2014	Time in	Out
What parts of the permit were assessed	Waste returns only		
Assessment	Report/data review	EPR Activity:	Installation: Waste Op: X Water Discharge:
Recipient's name/position	Unknown		
Officer's name	Louise H Field	Date issued	10/03/2014

Section 1 - Compliance Assessment Summary

This is based on the requirements of the permit under the Environmental Permitting Regulations. A detailed explanation and any action you may need to take are given in the "Detailed Assessment of Compliance" (section 3). This summary details where we believe any non-compliance with the permit has occurred, the relevant condition and how the non-compliance has been categorised using our Compliance Classification Scheme (CCS). CCS scores can be consolidated or suspended, where appropriate, to reflect the impact of some non-compliances more accurately. For more details of our CCS scheme, contact your local office.

Permit Conditions and Compliance Summary

Condition(s) breached

Category	Condition	Score	Condition(s) breached
a) Permitted activities	1. Specified by permit	N	
b) Infrastructure	1. Engineering for prevention & control of pollution	N	
	2. Closure & decommissioning	N	
	3. Site drainage engineering (clean & foul)	N	
	4. Containment of stored materials	N	
	5. Plant and equipment	N	
c) General management	1. Staff competency/ training	N	
	2. Management system & operating procedures	N	
	3. Materials acceptance	N	
	4. Storage handling, labelling, segregation	N	
d) Incident management	1. Site security	N	
	2. Accident, emergency & incident planning	N	
e) Emissions	1. Air	N	
	2. Land & Groundwater	N	
	3. Surface water	N	
	4. Sewer	N	
	5. Waste	N	
f) Amenity	1. Odour	N	
	2. Noise	N	
	3. Dust/fibres/particulates	N	
	4. Pests, birds & scavengers	N	
	5. Deposits on road	N	
g) Monitoring and records, maintenance and reporting	1. Monitoring of emissions & environment	N	
	2. Records of activity, site diary, journal & events	N	
	3. Maintenance records	N	
	4. Reporting & notification	C4	4.2.2
h) Resource efficiency	1. Efficient use of raw materials	N	
	2. Energy	N	

KEY: C1, C2, C3, C4 = CCS breach category (* suspended scores are marked with an asterisk),
A = Assessed (no evidence of non-compliance), N = Not assessed, NA = Not Applicable, O = Ongoing non-compliance – not scored

Number of breaches recorded	1	Total compliance score (see section 5 for scoring scheme)	0.1
------------------------------------	---	---	-----

If the Total No Breaches is greater than zero, then please see Section 3 for details of our proposed enforcement response

Schedule 3 – Emissions and monitoring

There are no emission limits or associated monitoring requirements.



This waste tonnage return form asks you to tell us about the types and quantities of controlled waste you have handled at your site.

Please complete a copy of this form every quarter and send it to us within 1 month of the end of the reporting quarter.

The Quarters are Q1: 1 January to 31 March, Q2: 1 April to 30 June, Q3: 1 July to 30 September, Q4: 1 October to 31 December.

How to use the form - Introductory notes

Please read through the whole form and these guidance notes before you start filling anything in.

Please note that if you have more than one facility covered by your permit/licence, you will need to combine all your figures for the facilities into a single return form.

When you fill in the form you will also need a copy of the GOR picklists.

This lists all of the items we need in sections 5 and 6, including:

- the district/county councils within your region
- List of Waste Regulations (LOWR) which give details of all European Waste Classification Codes (EWC)
- Disposal or Recovery codes

Please note that mandatory fields are marked with an asterisk.

Continuation Sheets

We have not sent you a continuation sheet. In the case that you need a continuation sheet for sections 5 or 6, please call us on 08708 506 506.

If you do use a continuation sheet(s), please make sure you label each sheet clearly with your waste permit number. *This can be found on the front of your licence/permit.*

You should also tell us how many continuation sheets you are using when you fill in section 7 'Declaration' of the form.

You can photocopy the form or continuation sheet if you then need further copies.

If you need help and advice

We have tried to make the form as straightforward as possible, but please get in touch with us if you:

- need any advice on how to set out the information we need
- have any other questions about the waste returns process

Please call our National Operator Returns Team on 08708 506 506 if you have any queries.

How to complete the form

Section 1 The return period and contact details

Please enter the appropriate quarter as months, as shown above and the year.

Please add the contact details for this return.

If any details are incorrect, the form will be sent back to you.

Section 2 Permit, operator and site details

Site Operator

Please enter your Permit number, and site operator details from your current waste management licence or permit.

Type of facility

Please enter the facility type from the details stated on your waste management licence or permit.

Section 3 Landfill sites only

Landfill operators should complete this section as at 31 March in the current year. Please complete question 2.5 even if you are making a 'nil return' which means that no waste has been received or removed from the site during the return period.

Remaining voidspace covered by the licence/permit

Please enter the remaining landfill void space covered by your licence or permit in cubic metres at 31 March in the current year. 'Void space' is the licensed/permitted capacity remaining at your site and this should only include areas covered by a waste management licence or permit and planning permission.

Section 4 Return details

Nil Return?

Please say whether you are submitting a nil return and state the reason for the nil return from the GOR picklist.

Was a weighbridge used?

Please say whether you used a weighbridge (either at your facility or a public weighbridge) before deposit. Enter the weighed proportion of waste accepted as a percentage.

There is an annual subsistence charge for your permit unless:

- your permit is only for discharges of sewage effluent where the maximum daily volume of discharge permitted is five cubic metres or less (this does not apply to non trade effluent or any other type of discharge);
- or your permit is only for mobile plant, instead we will charge for each deployment.

The annual charge is due on demand in the year that we issue the permit and then on 1 April each year. The charge starts from the date we authorise the permit, unless there's a condition relating to a standalone water discharge which states a later start date. In that case we will charge for the discharge from the start date. If you need to know more about the subsistence charge please look at the charging guidance on our website at <http://www.environment-agency.gov.uk/business/regulation/31857.aspx>

Rights of appeal

If you're not happy with any permit condition that has been imposed by the permit you may appeal to the Secretary of State. You must make your appeal no later than six months after the permit issue date. Further information about making an appeal and the forms you will need are available from the Planning Inspectorate website or from the contact details below.

The Planning Inspectorate, Environment Appeals Room 3/25 Hawk Wing, Temple Quay House,

2 The Square, Temple Quay, Bristol, BS1 6PN. **Phone:** 0117 3728726

Email: environment.appeals@pins.gsi.gov.uk

For Wales:

The Planning Inspectorate, Crown Buildings, Cathays Park, Cardiff, CF10 3NQ.

Phone: 029 2082 3866 / 389, **Fax:** 029 2082 5150 **Email:** wales@pins.gsi.gov.uk

You must send written notice of the appeal and the documents listed below to the Secretary of State and to the respective Planning Inspectorate address above. At the same time you must send us a copy of the notice and documents to

Victoria Balmer, Appeals Coordinator, Environment Agency, National Permitting Service, Knutsford Road, Latchford, Warrington, WA4 1HG.

Phone: 01925 542456 **Email :** victoria.balmer@environment-agency.gov.uk

The documents are:

- a statement of the grounds of appeal;
- a copy of any relevant application;
- a copy of any relevant environmental permit;
- a copy of any relevant correspondence between the appellant and the regulator;
- a copy of any decision or notice which is the subject matter of the appeal; and
- a statement indicating whether you wish the appeal to be in the form of a hearing or dealt with by way of written representations.

You may withdraw an appeal by notifying the Secretary of State in writing and sending a copy of that notification to us.

If you have any questions about this permit please phone our Customer Contact Centre on 03708 506 506. They will put you in touch with a local area officer.

Yours faithfully



Matthew Jubb
Permitting Support Advisor

Permitting and Support Centre, The Environment Agency, Quadrant 2,
99 Parkway Avenue, Parkway Business Park, Sheffield, S9 4WF
Customer services line: 03708 506 506

Email: psc@environment-agency.gov.uk Website: <http://www.environment-agency.gov.uk>

233_08_SD42, version 6

7 Declaration

Please make sure you have filled in all the sections that apply to you before signing this declaration.

I certify that the information in this return is correct to the best of my knowledge and belief.

I enclose _____ continuation sheets

Title _____

First name _____

Last name _____

Position _____

Phone _____

Date (DD/MM/YYYY) _____

Signature _____

The information you provide will be used by the Environment Agency to enable it to fulfill its regulatory and waste management planning responsibilities

8 The Data Protection Act 1998

We, the Environment Agency, will process the information you provide so that we can deal with your application, make sure you keep to the conditions of the license, permit or registration, process renewals and keep the public registers up to date.

- offer you documents or services relating to environmental matters
- consult the public, public organisations and other organisations (for example, the Health and Safety Executive, local authorities, the emergency services, the Department for Environment, Food and Rural Affairs) on environmental issues
- carry out research and development work on environmental issues
- provide information from the public register to anyone who asks
- prevent anyone from breaking environmental law, investigate cases where environmental law may have been broken, and take any action that is needed
- assess whether customers are satisfied with our service, and to improve our service, and
- respond to requests for information under the Freedom of Information Act 2000 and the Environmental Information Regulations 2004 (if the Data Protection Act allows).

We may pass the information on to our agents or representatives to do these things for us.



Environment
Agency

Permit with introductory note

The Environmental Permitting (England & Wales) Regulations 2010

Seales Road Haulage Limited

Seales Road Haulage Limited
20 Juliette Way
Purfleet Industrial Park
South Ockendon
Essex
RM15 4YD

Permit number
EPR/AB3408HK

Seales Road Haulage Limited

Permit number EPR/AB3408HK

Introductory note

This introductory note does not form a part of the permit

The main features of the permit are as follows.

Permit for the treatment of waste to produce soil, soil substitutes and aggregate. The facility is constructed of existing impermeable surfacing throughout with associated sealed tank drainage which is emptied by tanker when required. Roof water will discharge to surface water.

The status log of the permit sets out the permitting history, including any changes to the permit reference number.

Status log of the permit

Description	Date	Comments
Application EPR/AB3408/A001	Duly made 08/08/2013	Application for treatment of waste to produce soil, soil substitutes and aggregate.
Additional information received	08/08/2013	Copy of WAMITAB certificate
Permit determined	30/10/2013	Permit issued to Seales Road Haulage Limited

End of introductory note

Permit

The Environmental Permitting (England and Wales) Regulations 2010

Permit number
EPR/AB3408HK

The Environment Agency hereby authorises, under regulation 13 of the Environmental Permitting (England and Wales) Regulations 2010

Seales Road Haulage Limited ("the operator"),
whose registered office is

14 Broadway
Rainham
Essex
RM13 9YW

company registration number **03049905**

to operate waste operations at

Seales Road Haulage Limited
20 Juliette Way
Purfleet Industrial Estate
South Ockendon
Essex
RM15 4YD

to the extent authorised by and subject to the conditions of this permit.

Name	Date
Philip Lamb	30/10/2013

Authorised on behalf of the Environment Agency

Conditions

1 Management

1.1 General management

- 1.1.1 The operator shall manage and operate the activities:
- (a) in accordance with a written management system that identifies and minimises risks of pollution, including those arising from operations, maintenance, accidents, incidents, non-conformances, closures and those drawn to the attention of the operator as a result of complaints; and
 - (b) using sufficient competent persons and resources.
- 1.1.2 Records demonstrating compliance with condition 1.1.1 shall be maintained.
- 1.1.3 Any person having duties that are or may be affected by the matters set out in this permit shall have convenient access to a copy of it kept at or near the place where those duties are carried out.
- 1.1.4 The operator shall comply with the requirements of an approved competence scheme

1.2 Avoidance, recovery and disposal of wastes produced by the activities

- 1.2.1 The operator shall take appropriate measures to ensure that:
- (a) the waste hierarchy referred to in Article 4 of the Waste Framework Directive is applied to the generation of waste by the activities; and
 - (b) any waste generated by the activities is treated in accordance with the waste hierarchy referred to in Article 4 of the Waste Framework Directive; and
 - (c) where disposal is necessary, this is undertaken in a manner which minimises its impact on the environment.
- 1.2.2 The operator shall review and record at least every four years whether changes to those measures should be made and take any further appropriate measures identified by a review.

2 Operations

2.1 Permitted activities

- 2.1.1 The operator is only authorised to carry out the activities specified in schedule 1 table S1.1 (the "activities").

2.2 The site

- 2.2.1 The activities shall not extend beyond the site, being the land shown edged in green on the site plan at schedule 7 to this permit.

2.3 Operating techniques

- 2.3.1 (a) The activities shall, subject to the conditions of this permit, be operated using the techniques and in the manner described in the documentation specified in schedule 1, table S1.2, unless otherwise agreed in writing by the Environment Agency.
- (b) If notified by the Environment Agency that the activities are giving rise to pollution, the operator shall submit to the Environment Agency for approval within the period specified, a revision of any plan or other documentation ("plan") specified in schedule 1, table S1.2 or otherwise required under this permit which identifies and minimises the risks of pollution relevant to that plan, and shall implement the approved revised plan in place of the original from the date of approval, unless otherwise agreed in writing by the Environment Agency.
- 2.3.2 Waste shall only be accepted if:
- (a) it is of a type and quantity listed in schedule 2 table S2.1
- (b) it conforms to the description in the documentation supplied by the producer and holder

3 Emissions and monitoring

3.1 Emissions of substances not controlled by emission limits

- 3.1.1 Emissions of substances not controlled by emission limits (excluding odour) shall not cause pollution. The operator shall not be taken to have breached this condition if appropriate measures, including, but not limited to, those specified in any approved emissions management plan, have been taken to prevent or where that is not practicable, to minimise, those emissions.
- 3.1.2 The operator shall:
- (a) if notified by the Environment Agency that the activities are giving rise to pollution, submit to the Environment Agency for approval within the period specified, an emissions management plan which identifies and minimises the risks of pollution from emissions of substances not controlled by emission limits;
- (b) implement the approved emissions management plan, from the date of approval, unless otherwise agreed in writing by the Environment Agency.

3.2 Odour

- 3.2.1 Emissions from the activities shall be free from odour at levels likely to cause pollution outside the site, as perceived by an authorised officer of the Environment Agency, unless the operator has used appropriate measures, including, but not limited to, those specified in any approved odour management plan, to prevent or where that is not practicable to minimise the odour.
- 3.2.2 The operator shall:
- (a) if notified by the Environment Agency that the activities are giving rise to pollution outside the site due to odour, submit to the Environment Agency for approval within the period specified, an odour management plan which identifies and minimises the risks of pollution from odour;

- (b) implement the approved odour management plan, from the date of approval, unless otherwise agreed in writing by the Environment Agency.

3.3 Noise and vibration

- 3.3.1 Emissions from the activities shall be free from noise and vibration at levels likely to cause pollution outside the site, as perceived by an authorised officer of the Environment Agency, unless the operator has used appropriate measures, including, but not limited to, those specified in any approved noise and vibration management plan to prevent or where that is not practicable to minimise the noise and vibration.
- 3.3.2 The operator shall:
 - (a) if notified by the Environment Agency that the activities are giving rise to pollution outside the site due to noise and vibration, submit to the Environment Agency for approval within the period specified, a noise and vibration management plan which identifies and minimises the risks of pollution from noise and vibration;
 - (b) implement the approved noise and vibration management plan, from the date of approval, unless otherwise agreed in writing by the Environment Agency.

4 Information

4.1 Records

- 4.1.1 All records required to be made by this permit shall:
 - (a) be legible;
 - (b) be made as soon as reasonably practicable;
 - (c) if amended, be amended in such a way that the original and any subsequent amendments remain legible, or are capable of retrieval; and
 - (d) be retained, unless otherwise agreed in writing by the Environment Agency, for at least 6 years from the date when the records were made, or in the case of the following records until permit surrender:
 - (i) off-site environmental effects; and
 - (ii) matters which affect the condition of the land and groundwater.
- 4.1.2 The operator shall keep on site all records, plans and the management system required to be maintained by this permit, unless otherwise agreed in writing by the Environment Agency.

4.2 Reporting

- 4.2.1 The operator shall send all reports and notifications required by the permit to the Environment Agency using the contact details supplied in writing by the Environment Agency.
- 4.2.2 Within one month of the end of each quarter, the operator shall submit to the Environment Agency using the form made available for the purpose, the information specified on the form relating to the site and the waste accepted and removed from it during the previous quarter.

- 4.2.3 The operator shall submit to the Environment Agency a bi-annual report of the efficiency of the biofilter in the first year of compost operations. This shall include but not be limited to, the assessment of the efficiency to reduce odours, the summary of maintenance and any recommissioning planned or conducted, assessment of back pressure, venting and cracking. Thereafter the operator shall submit the report within one month of the end of each year, unless otherwise agreed in writing by the Environment Agency.

4.3 Notifications

- 4.3.1 The Environment Agency shall be notified without delay following the detection of:

- (a) any malfunction, breakdown or failure of equipment or techniques, accident, or emission of a substance not controlled by an emission limit which has caused, is causing or may cause significant pollution;
- (b) the breach of a limit specified in the permit; or
- (c) any significant adverse environmental effects.

- 4.3.2 Any information provided under condition 4.3.1 shall be confirmed by sending the information listed in schedule 5 to this permit within the time period specified in that schedule.

- 4.3.3 Where the Environment Agency has requested in writing that it shall be notified when the operator is to undertake monitoring and/or spot sampling, the operator shall inform the Environment Agency when the relevant monitoring and/or spot sampling is to take place. The operator shall provide this information to the Environment Agency at least 14 days before the date the monitoring is to be undertaken.

- 4.3.4 The Environment Agency shall be notified within 14 days of the occurrence of the following matters, except where such disclosure is prohibited by Stock Exchange rules:

Where the operator is a registered company:

- (a) any change in the operator's trading name, registered name or registered office address; and
- (b) any steps taken with a view to the operator going into administration, entering into a company voluntary arrangement or being wound up.

Where the operator is a corporate body other than a registered company:

- (a) any change in the operator's name or address; and
- (b) any steps taken with a view to the dissolution of the operator.

In any other case:

- (a) the death of any of the named operators (where the operator consists of more than one named individual);
- (b) any change in the operator's name(s) or address(es); and
- (c) any steps taken with a view to the operator, or any one of them, going into bankruptcy, entering into a composition or arrangement with creditors, or, in the case of them being in a partnership, dissolving the partnership.

4.3.5 Where the operator proposes to make a change in the nature or functioning, or an extension of the activities, which may have consequences for the environment and the change is not otherwise the subject of an application for approval under the Regulations or this permit:

- (a) the Environment Agency shall be notified at least 14 days before making the change; and
- (b) the notification shall contain a description of the proposed change in operation.

4.4 Interpretation

4.4.1 In this permit the expressions listed in schedule 6 shall have the meaning given in that schedule.

4.4.2 In this permit references to reports and notifications mean written reports and notifications, except where reference is made to notification being made "without delay", in which case it may be provided by telephone.

Time periods for notification following detection of a breach of a limit	
Parameter	Notification period

(c) Notification requirements for the detection of any significant adverse environmental effect	
To be notified within 24 hours of detection	
Description of where the effect on the environment was detected	
Substances(s) detected	
Concentrations of substances detected	
Date of monitoring/sampling	

Part B - to be submitted as soon as practicable

Any more accurate information on the matters for notification under Part A.	
Measures taken, or intended to be taken, to prevent a recurrence of the incident	
Measures taken, or intended to be taken, to rectify, limit or prevent any pollution of the environment which has been or may be caused by the emission	
The dates of any unauthorised emissions from the facility in the preceding 24 months.	

Name*	
Post	
Signature	
Date	

* authorised to sign on behalf of the operator

Time periods for notification following detection of a breach of a limit	
Parameter	Notification period

(c) Notification requirements for the detection of any significant adverse environmental effect	
To be notified within 24 hours of detection	
Description of where the effect on the environment was detected	
Substances(s) detected	
Concentrations of substances detected	
Date of monitoring/sampling	

Part B - to be submitted as soon as practicable

Any more accurate information on the matters for notification under Part A.	
Measures taken, or intended to be taken, to prevent a recurrence of the incident	
Measures taken, or intended to be taken, to rectify, limit or prevent any pollution of the environment which has been or may be caused by the emission	
The dates of any unauthorised emissions from the facility in the preceding 24 months.	

Name*	
Post	
Signature	
Date	

* authorised to sign on behalf of the operator

**Office use only**

Sent requiring correction (DD/MM/YYYY)

Date of issue (DD/MM/YYYY)

Return rejected (DD/MM/YYYY)

Date received (DD/MM/YYYY)

Return submitted (DD/MM/YYYY)

Use this form to tell us the type and quantity of controlled waste you have processed on your site over the last quarter. Please read through the whole form and guidance notes before you start filling anything in. **Mandatory fields marked by ***

Your return must be submitted within the following period:

After: _____ and before: _____

Failure to comply with these dates may result in enforcement.

When completed please post to:

**National Operator Returns Team
The Environment Agency
Customer Contact Centre
Quadrant Two
99 Parkway Avenue
Sheffield
S9 4WF**

Please contact 08708 506 506 if you have any queries.

1 Return period and contact details

Return period *

Quarterly

Contact name for this return *

Peter Seales

Position *

MD

Contact tel. *

01708 865110

Contact email

2 Permit, operator and site details

Permit No. *

EPT/AB3408HK/A001

Site operator name *

SEALES RD Haulage LTD

Site name *

SEALES RD Haulage LTD

Site address *

17 Jewlett way
Purfleet Ind Est
South Ockendon

Postcode *

RM15 4YD

Type of facility *

2 Permit, operator and site details, continued

Are you operating a landfill? *

Yes No

If yes, go to Section 3. If you are not operating a landfill, go to Section 4.

3 Landfill sites only

This section must be completed for landfill sites.

Remaining void space covered by this permit

_____ cubic metres.

Method of calculating void space

Date last surveyed or estimated (DD/MM/YYYY)

4 Return details

Are you submitting a nil return?*

Yes No

If submitting a nil return, state reason for nil return, then go to the Declaration – Section 7 on page 2.

If not submitting a nil return was a weighbridge used?

(Complete this if your answer to 4 was No)Yes No

If yes, give percentage weighed

_____ %

Now go to Sections 5 and 6 (Waste received and Waste removed).

Section 5 Waste received on site

Before you complete this section make sure you have a copy of the GOR picklists which lists all of the items we need in section 5, including:

- List of Waste (England) Regulations 2005 (LOWR) which gives details of all European Waste Codes
- A list of the district/county councils

We need to know about each batch of waste you receive from a different source. For each batch please give:

- its place of origin.
- details of the waste (EWC code, physical state, amount, units used) processed at this site.

Please use the continuation sheet available on request, or a copy of it, if you need to.

Origin

Please enter the local authority district where the waste originated. If the district is not known, enter the county council or planning region where the waste originated.

A list of district/counties is included in the GOR picklists.

EWC Code

Please enter the EWC code as shown in the List of Waste (England) Regulations 2005 and GOR picklists.

Disposal or Recovery Code

Please enter the Disposal or Recovery code as shown in the GOR picklists that is relevant to this waste received.

State

Please enter the physical state of the waste (*whether it is solid, liquid, powder, sludge or gas*).

From another facility

Please enter the type of facility where the waste came from as shown in the GOR picklists.

Amount in tonnes

Please give the amount in tonnes of each specific waste type received from each district of origin.

Units

Please note that quantities of waste must be reported using units of Tonnes. To convert other units to Tonnes please use our waste conversion factors which are available from our website or by contacting us.

Pre-treatment

Please select from the list of pre-treatment options included in the GOR picklists.

Section 6 Waste removed from site

Before you complete this section make sure you have a copy of the GOR picklists which lists all of the items we need in section 6, including:

- List of Waste (England) Regulations 2005 (LOWR) which gives details of all European Waste Codes
- A list of the district/county councils

We need to know about each batch of waste you send to a different source. For each batch please give:

- the destination you are sending it to
- details of the waste (EWC code, physical state, amount, units used) removed from this type.

Please use the continuation sheet available on request, or a copy of it, if you need to.

Destination

Please enter the local authority district where the waste is sent. If the district is not known, enter the county council or planning region of destination.

A list of district/counties is included in the GOR picklists.

EWC Code

Please enter the EWC code as shown in the List of Waste (England) Regulations 2005 and GOR picklists.

State

Please enter the physical state of the waste (*whether it is solid, liquid, powder, sludge or gas*).

Destination facility Disposal or Recovery Code

Please enter the Disposal or Recovery code as shown in the GOR picklists that is relevant to this waste removed.

Amount in tonnes

Please give the amount in tonnes of each specific waste type removed to each district.

Units

Please note that quantities of waste must be reported using units of Tonnes. To convert other units to Tonnes please use our waste conversion factors which are available from our website or by contacting us.

Sending the form back to us

You should return the form back to us:

- no later than one month after the quarter end
- using the address printed at the top of page 1 of the form

Additional Information

For general enquiries please call our general enquiry number 08708 506 506 between 8.00am and 6.00pm.